

Step	Description	Image/Info
1	Use the kiosk keys to unlock the back panel of the kiosk.	 <p>The diagram shows the back of a grey kiosk. A red circle highlights a keyhole on the upper right side of the back panel. A red curved arrow points from the right towards this keyhole. The kiosk has a yellow top section and a green circular logo at the bottom of the back panel.</p>

2

Power down the unit by turning the power strip to the OFF position.

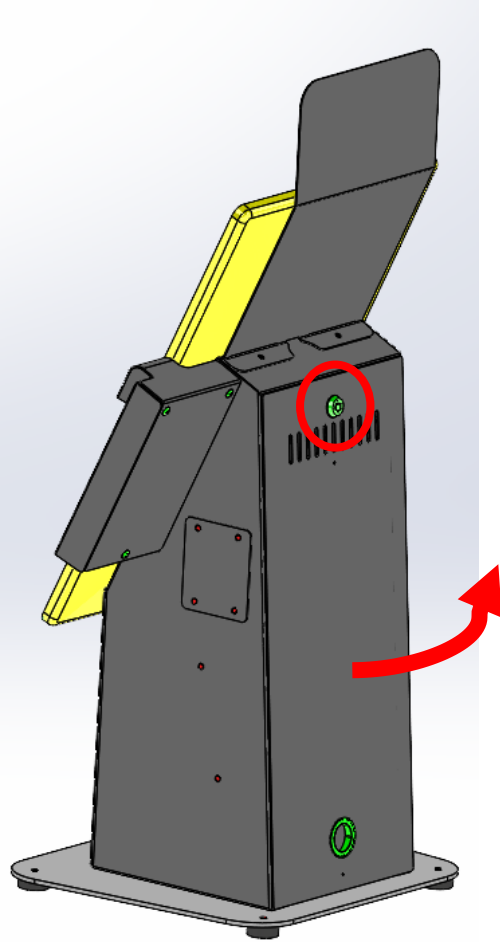
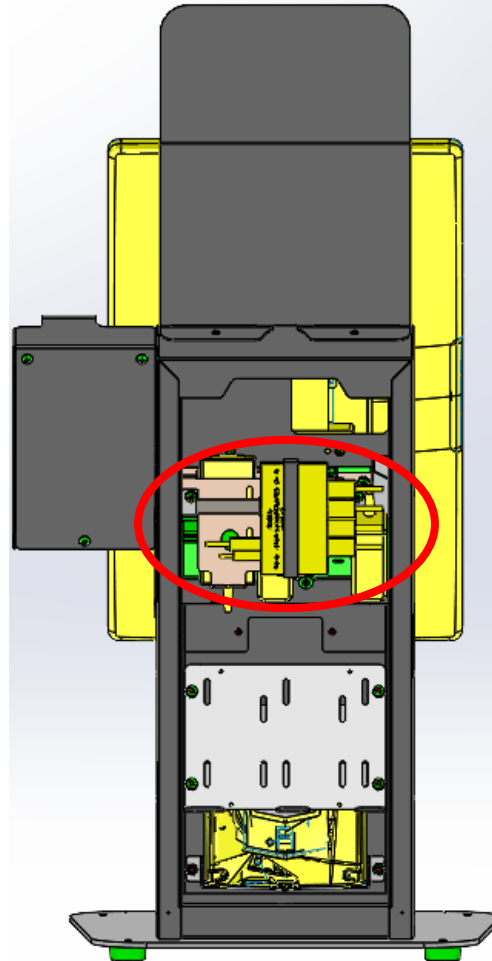

3

Use a #2 Phillips screwdriver to remove (3X) 8-32 screws and remove the payment back cover plate. Set them aside.

They will be used in a future step.

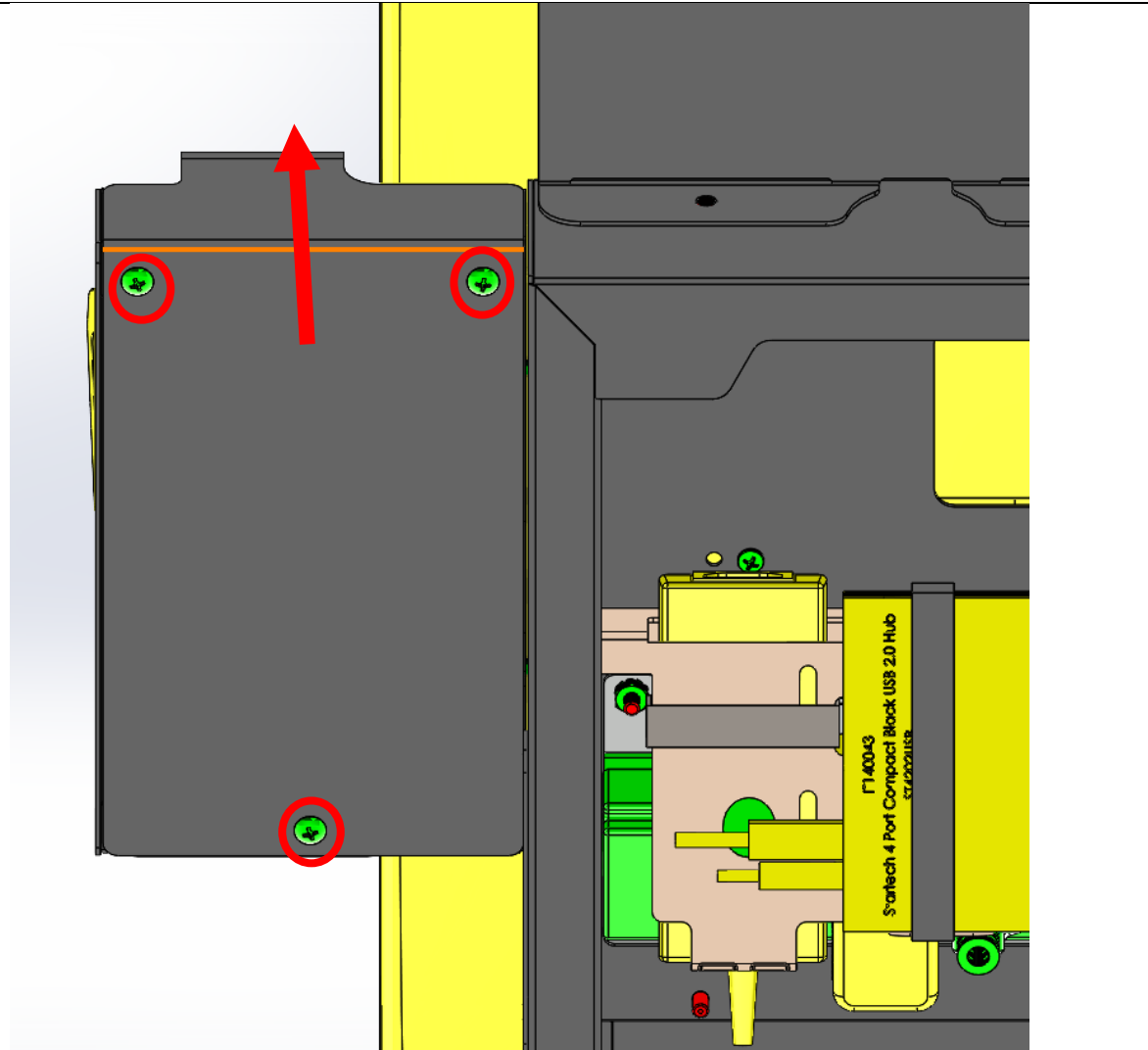

4

Use a 3/8 socket or wrench to remove the (2X) 10-32 nuts holding the payment device brackets. Set them aside for a future step.

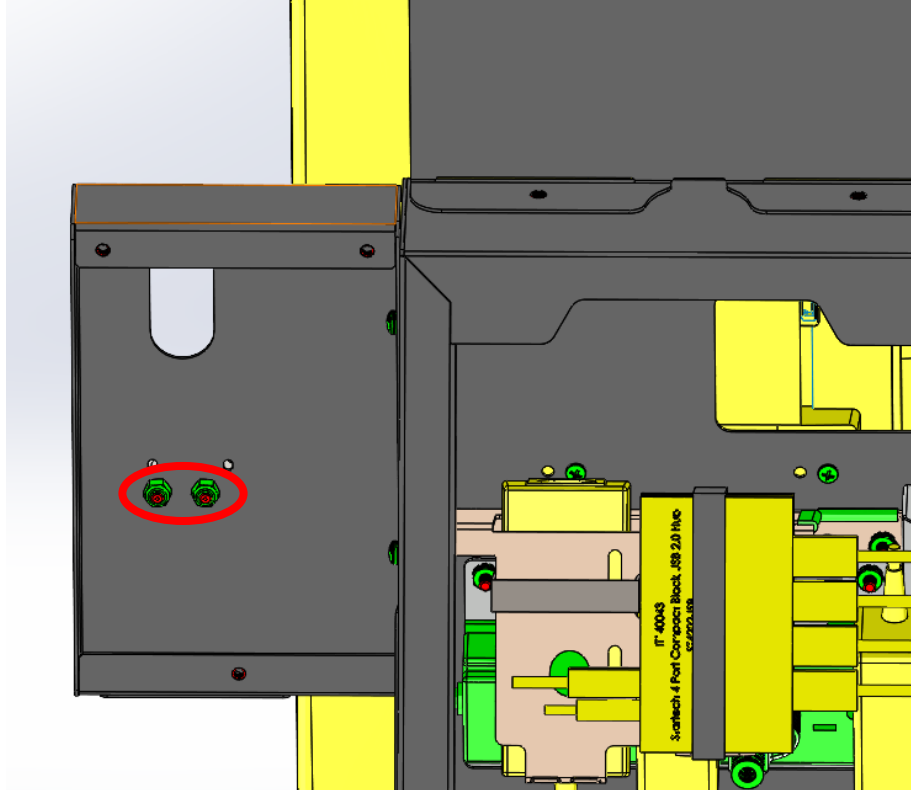

5

Payment device brackets (shown on the right-hand side) can now be removed.

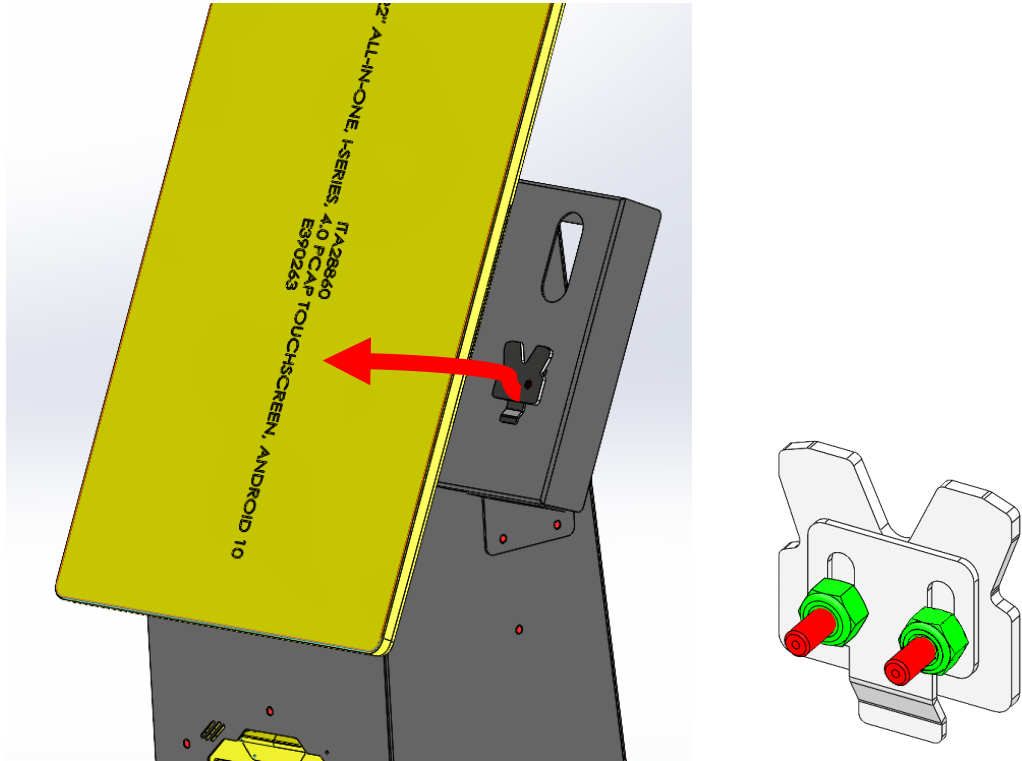

6

Use a 3/8" socket or wrench to slightly loosen the 10-32 nuts on the payment device brackets. Do not remove them completely.

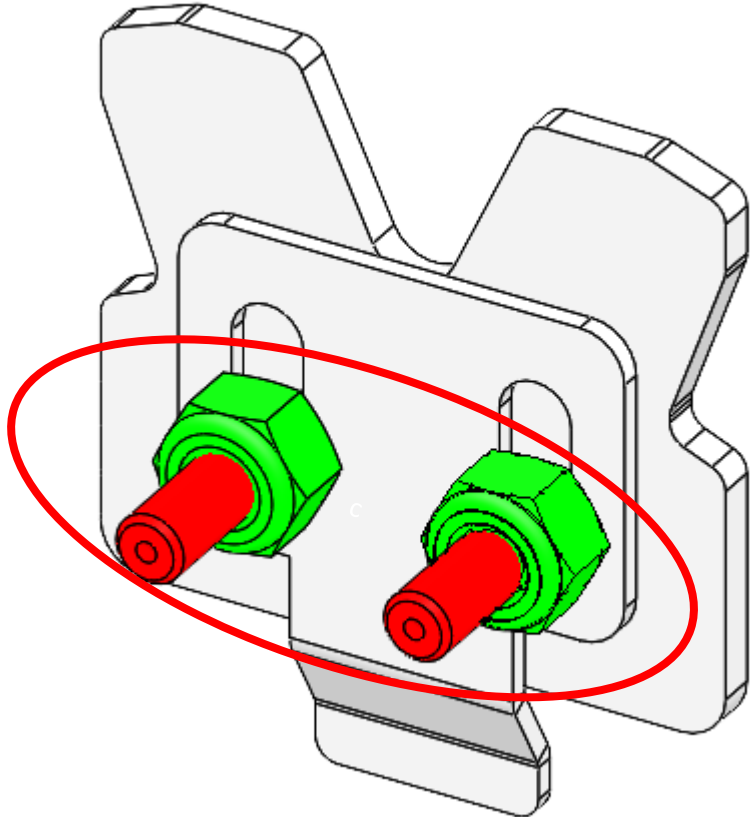

7

Install payment device bracket (shown in blue) by sliding it onto the pocket on the back of the Ingenico Lane 3000 device.

When working with or handling the payment device, make sure to work on a clean, padded surface as to not scratch/damage the device.

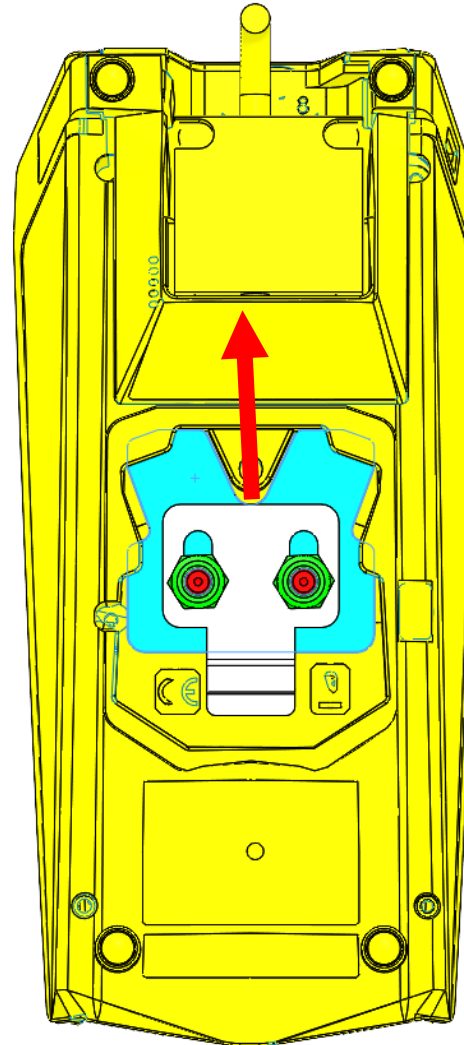

8

Slide the secondary bracket (shown in blue) as far down as it will go. Use a 3/8" socket to secure the (2X) 10-32 nuts in place.

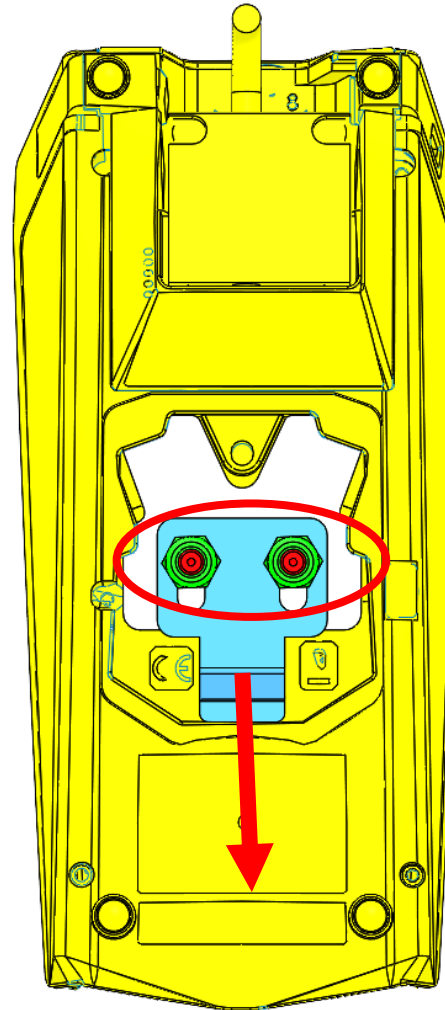

9

Feed the payment device cables through the hole on the side of the kiosk and connect it to the back of the payment device.

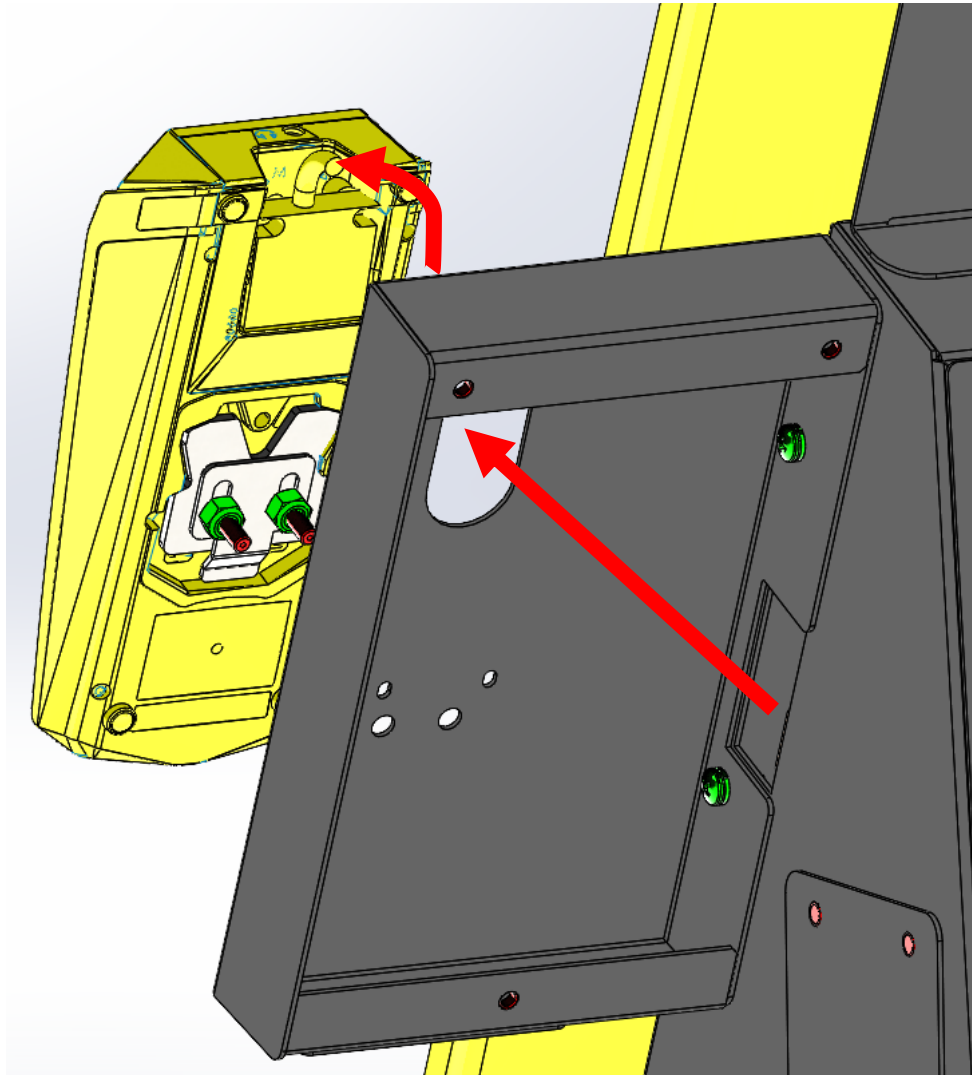

10

Use a 3/8" socket to fasten the payment device with the (2X) 10-32 nuts previously removed on step 4.

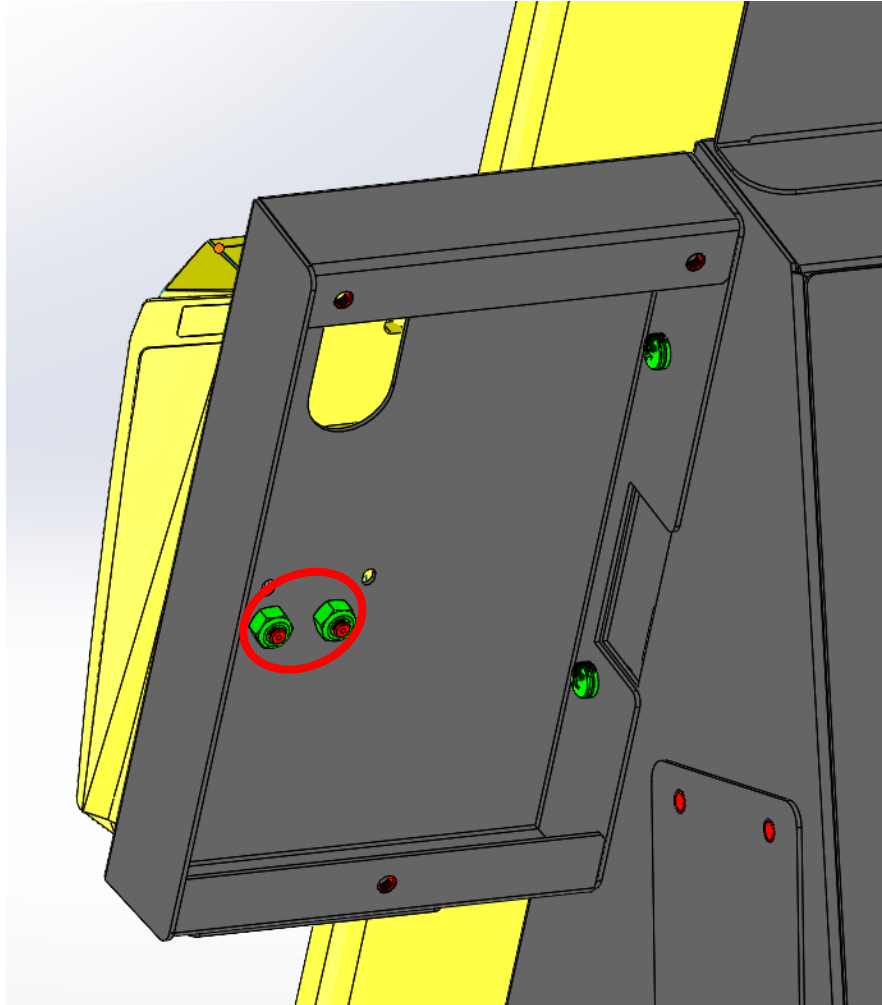

11

Confirm Payment device cables are connected as needed (per manufacturer's instructions).

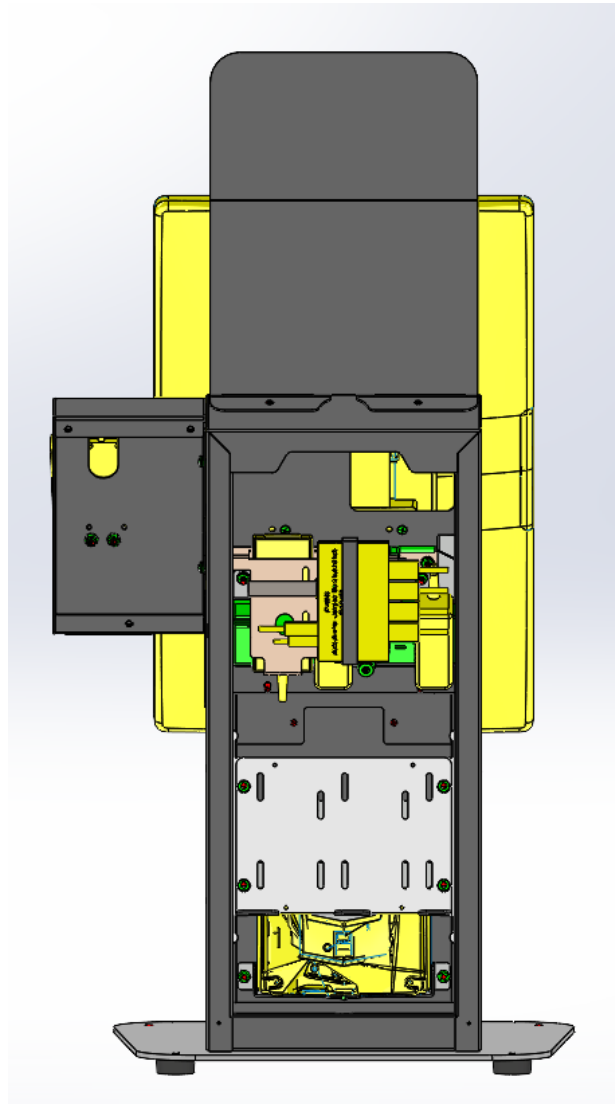

12

Use a #2 Phillips screwdriver to re-install the payment back cover plate with the (3X) 8-32 screws from Step 3.

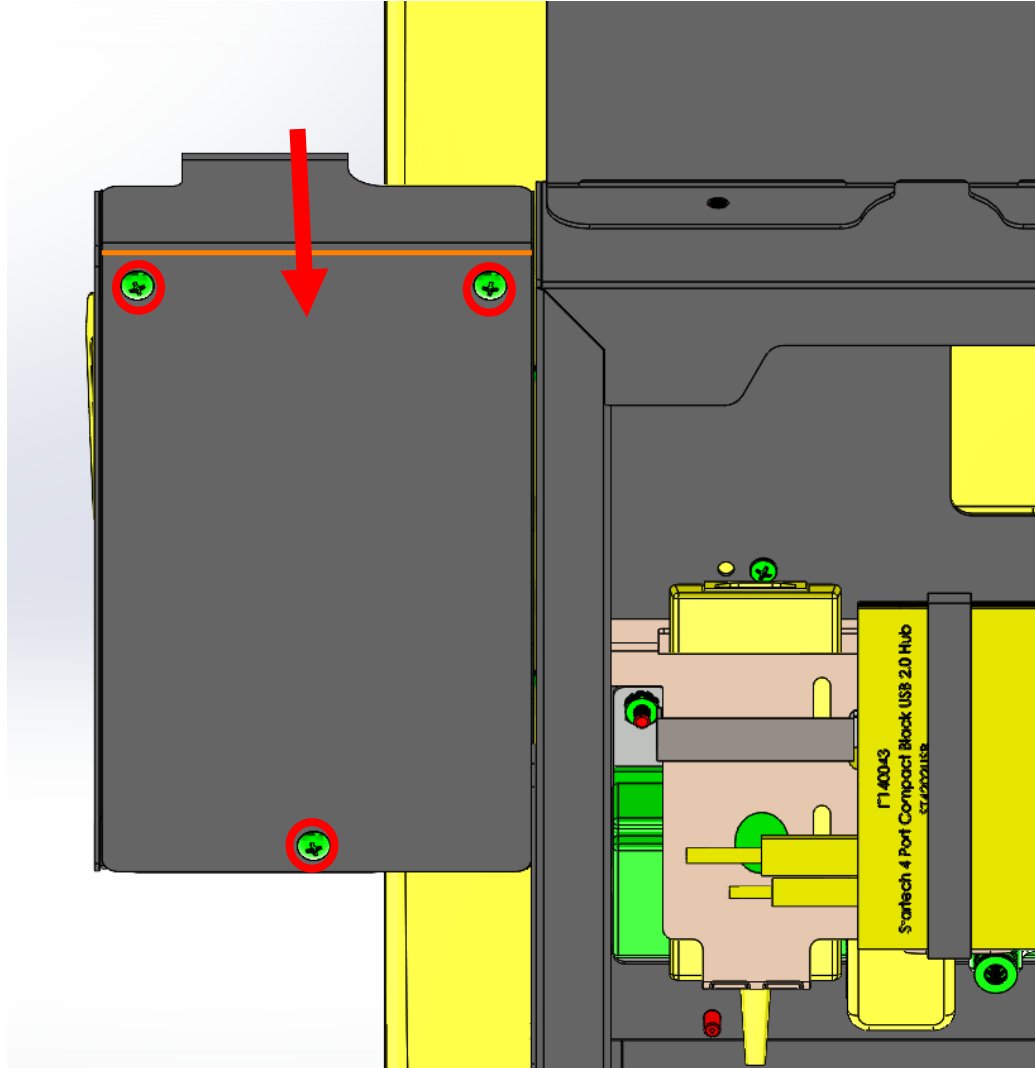

13

Power the unit on by turning the power strip to the ON position.

Assemble the back panel onto the kiosk and lock in place with the key.

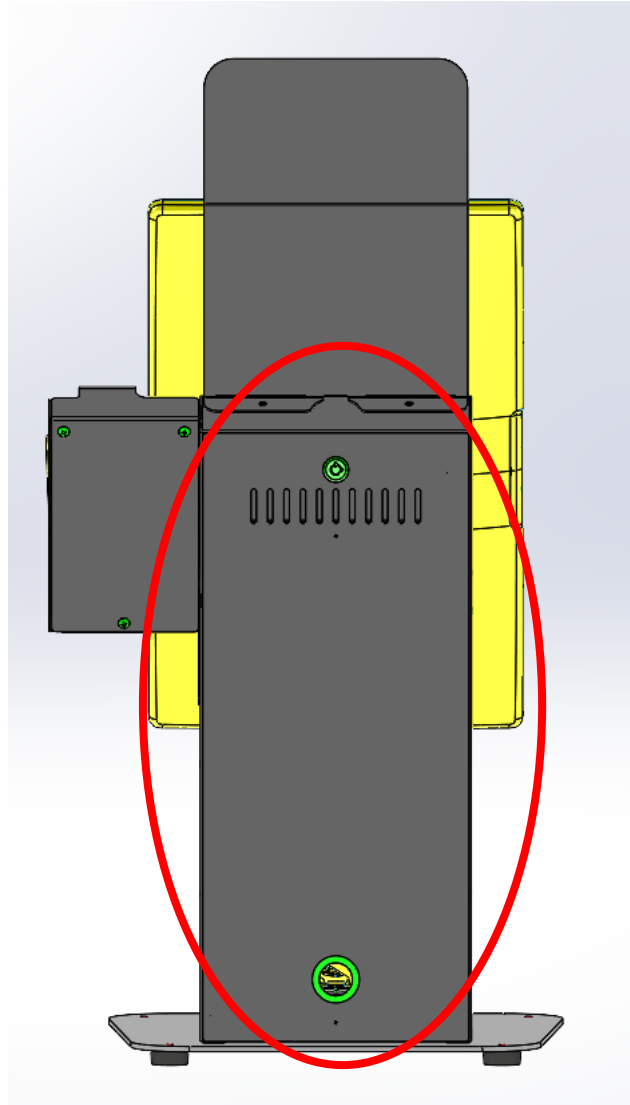

14

Final look of kiosk with Ingenico Lane 3000.

